

Manual

Table Saw with Stand

2.5 Hp
Power

Applies for:

Model

Code

SME-10B

101796

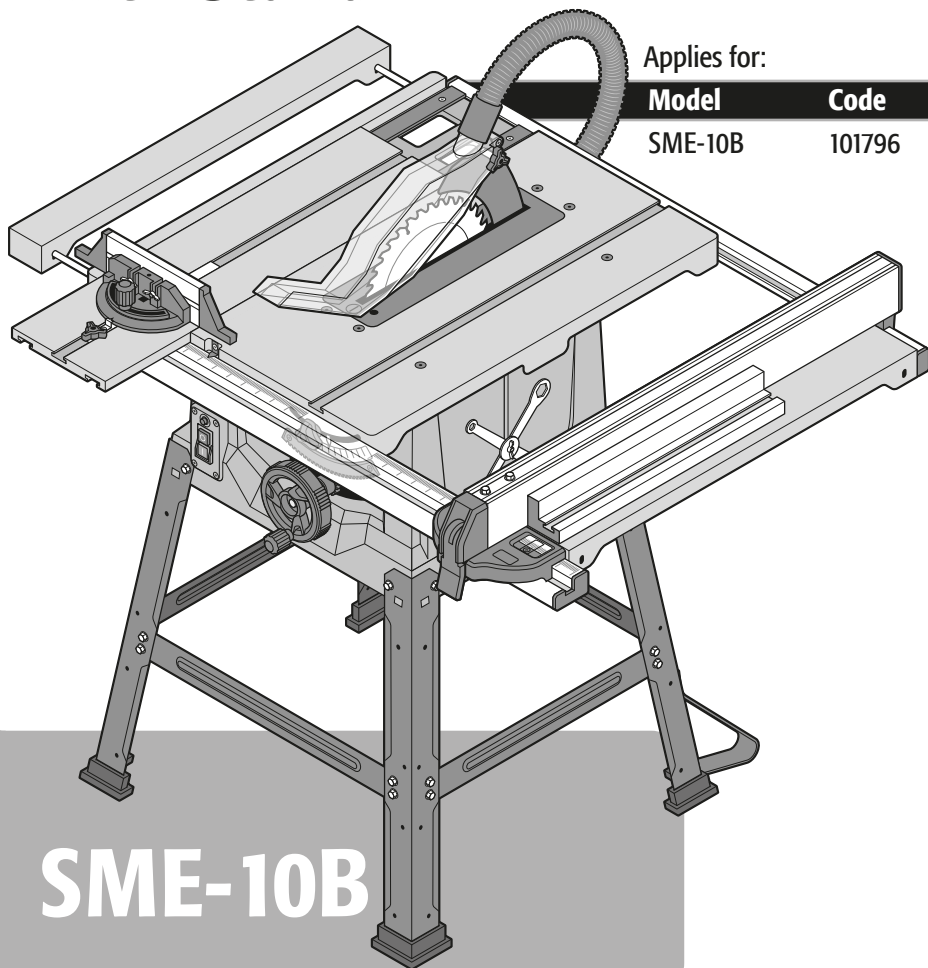

SME-10B

 **CAUTION**



Read this manual thoroughly
before using the tool.



Technical data.....	3
Power requirements.....	3
 General power tool safety warnings	4
 General safety warnings for electric saws	5
Parts list.....	6
Assembly	7
Parts.....	11
Settings.....	13
Operation.....	16
Maintenance.....	18
Troubleshooting.....	19
Notes.....	20
Authorized service centers	21
Warranty policy.....	22

CAUTION

To gain the best performance of the tool, prolong the duty life, make the Warranty valid if necessary, and to avoid hazards of fatal injuries please read and understand this Manual before using the tool.

Keep this manual for future references.

The illustrations in this manual are for reference only. They might be different from the real tool.

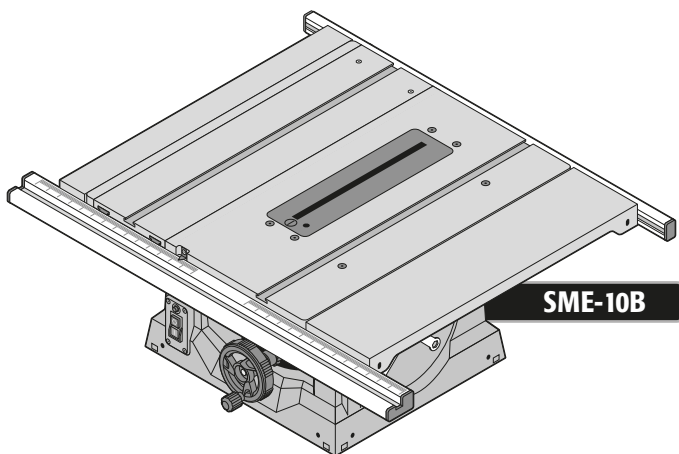

SME-10B

Technical data



SME-10B

Code	101796		
Description	Table saw with stand		
Maximum cutting capacity left / right	20" x 27 5/32" extendable up to 47"		
Maximum 90° cutting capacity	3 1/4"		
Maximum 45° cutting capacity	2 1/4"		
Bevel range	0°- 45°		
Axis diameter	5/8"		
Disc	10" - 40 Tungsten carbide teeth and 5/8" shaft		
Voltage	127 V ~	Frequency	60 Hz
Current	15 A	Power	2.5 Hp
Speed	5 000 RPM		
Work cycle	50 min of work and 20 min of rest. Daily maximum of 6 hours.		
Conductors	14 AWG x 2 C with insulation temperature of 221 °F		
Insulation	Class II		

The power cable has a cable clamp type: Y
The construction class of the tool is: Reinforced insulation.
Thermal insulation class of the motor windings: Class B

⚠ WARNING Avoid the risk of electric shock or severe injury. When the power cable gets damaged it should only be replaced by the manufacturer or at a **TRUPER** Authorized Service Center. The build quality of the electric insulation is altered if spills or liquid gets into the tool while in use. Do not expose to rain, liquids and/or dampness.

⚠ WARNING Before gaining access to the terminals all power sources should be disconnected.



Power requirements

⚠ WARNING Tools with double insulation and reinforced insulation are built with a polarized plug (one prong is wider than the other) This plug fits in any polarized outlet and can only be connected one way. If the plug does not fit completely into the outlet, reverse the plug. If it is not fitting, call a qualified electrician or install a polarized outlet. Do not alter the plug in any way. Double insulation eliminates the need of a three-prong grounded power plug or a grounded electric system.

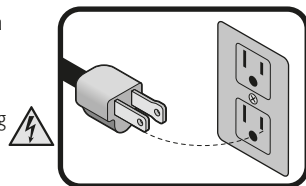

⚠ WARNING When using an extension cable, make it has sufficient gauge to carry the current your tool will draw. A lower gauge cable will cause voltage drop in the line, resulting in power loss and the motor will overheat. The following table shows the right size to use depending on cable's length and the ampere capability shown in the tool's nameplate. When in doubt use the next higher gauge.

Ampere Capacity	Number of Conductors	Extension Gauge	
		From 6 ft to 49 ft	Higher than 49 ft
From 0 and up to 10 A	3 (one grounded)	18 AWG	16 AWG
From 10 and up to 13 A		16 AWG	14 AWG
From 13 and up to 15 A		14 AWG	12 AWG
From 15 and up to 20 A		8 AWG	6 AWG

⚠ WARNING When using power tools outdoors use **SVOLTECK** grounded extension cable labeled "Outdoors Use". These extension cables are specially manufactured for outdoors use and reduce the risk of electric shock.



ENGLISH

3



General power tools safety warnings



⚠ WARNING! Read carefully all safety warnings and instructions listed below. Failure to comply with any of these warnings may result in electric shock, fire and / or severe damage. **Save all warnings and instructions for future references.**

Work area

Keep your work area clean, and well lit.

Cluttered and dark areas may cause accidents.



Never use the tool in explosive atmospheres, such as in the presence of flammable liquids, gases or dust.

Sparks generated by power tools may ignite the flammable material.



Keep children and bystanders at a safe distance while operating the tool.

Distractions may cause losing control.



Electrical Safety

The tool plug must match the power outlet. Never modify the plug in any way. Do not use any adapter plugs with grounded power tools.

Modified plugs and different power outlets increase the risk of electric shock.



Avoid body contact with grounded surfaces, such as pipes, radiators, electric ranges and refrigerators.

The risk of electric shock increases if your body is grounded.

Do not expose the tool to rain or wet conditions.

Water entering into the tool increases the risk of electric shock.

Do not force the cord. Never use the cord to carry, lift or unplug the tool. Keep the cord away from heat, oil, sharp edges or moving parts.

Damaged or entangled cords increase the risk of electric shock.

When operating a tool outdoors, use an extension cord suitable for outdoor use.

Using an adequate outdoor extension cord reduces the risk of electric shock.

If operating the tool in a damp location cannot be avoided, use a ground fault circuit interrupter (GFCI) protected supply.

Using a GFCI reduces the risk of electric shock.

Personal safety

Stay alert, watch what you are doing and use common sense when operating a tool. Do not use a power tool while you are tired or under the influence of drugs, alcohol or medication.

A moment of distraction while operating the tool may result in personal injury.

Use personal protective equipment. Always wear eye protection.

Protective equipment such as safety glasses, anti-dust mask, non-skid shoes, hard hats and hearing protection used in the right conditions significantly reduce personal injury.



Prevent unintentional starting up. Ensure the switch is in the "OFF" position before connecting into the power source and / or battery as well as when carrying the tool.

Transporting power tools with the finger on the switch or connecting power tools with the switch in the "ON" position may cause accidents.

Remove any wrench or vice before turning the power tool on.

Wrenches or vices left attached to rotating parts of the tool may result in personal injury.

Do not overreach. Keep proper footing and balance at all times.

This enables a better control on the tool during unexpected situations.

Dress properly. Do not wear loose clothing or jewelry. Keep hair, clothes and gloves away from the moving parts.

Loose clothes or long hair may get caught in moving parts.



If you have dust extraction and recollection devices connected onto the tool, inspect their connections and use them correctly.

Using these devices reduce dust-related risks.

Power Tools Use and Care

Do not force the tool. Use the adequate tool for your application.

The correct tool delivers a better and safer job at the rate for which it was designed.



Do not use the tool if the switch is not working properly.

Any power tool that cannot be turned ON or OFF is dangerous and should be repaired before operating.

Disconnect the tool from the power source and / or battery before making any adjustments, changing accessories or storing.

These measures reduce the risk of accidentally starting the tool.

Store tools out of the reach of children. Do not allow persons that are not familiar with the tool or its instructions to operate the tool.

Power tools are dangerous in the hands of untrained users.



Service the tool. Check the mobile parts are not misaligned or stuck. There should not be broken parts or other conditions that may affect its operation. Repair any damage before using the tool.

Most accidents are caused due to poor maintenance to the tools.



Keep the cutting accessories sharp and clean.

Cutting accessories in good working conditions are less likely to bind and are easier to control.

Use the tool, components and accessories in accordance with these instructions and the projected way to use it for the type of tool when in adequate working conditions.

Using the tool for applications different from those it was designed for, could result in a hazardous situation.

Service

Repair the tool in a TRUPER Authorized Service Center using only identical spare parts.

This will ensure that the safety of the power tool is maintained.

Children or people with reduced physical, sensory or mental capabilities shall not operate the tool, neither inexperienced people or without knowledge in the use of the tool, unless supervised by a person responsible of their safety or if receiving previous instructions about the tool operation.

Children shall be kept under supervision to double-check they will not play with the tool. Tight supervision shall be used with children or disabled persons to prevent from using or being close to any household tool.



Before operating the saw

⚠ CAUTION • Obtain training from a qualified person familiar with the equipment and its operation.

- Do not use the equipment if you have difficulty in performing any operation. Contact your supervisor, instructor or the service center immediately.
- Before disconnecting and connecting the equipment, you must switch the power switch to off (see page 16, section on and off).



⚠ CAUTION • Check that the cut-off disc is properly mounted before switching on the equipment.

- Make sure that the disc is sharp, in good condition, well aligned, free of rust and tar.
- Before turning on the equipment, make sure that the cut-off disc is not in contact with the work piece.
- All parts must be correctly installed.

While operating the saw

⚠ WARNING • Always keep your hands away from the cut-off disc.

⚠ WARNING • Do not do any hands-free operation. Use the saw fence for straight cuts and the miter fence for angled cuts. Always use the push stick (A) to control small work pieces.

⚠ CAUTION • The direction of feed of the work piece should always be against the sprockets of the disc, and should be at a constant and moderate speed.

- Work pieces should have flat faces; never work on warped or twisted wood or round wood.

⚠ WARNING • Avoid positions and movements that may cause your hands or body to move toward the moving disc.

- Turn off the power and wait for the cut-off disc to come to a complete stop before removing excess work pieces from the table.

- When a work piece requires more than one cut, turn the power off and wait for the cut-off disc to come to a complete stop before positioning the work piece for subsequent cuts.

- When making angled cuts using the miter gauge, remove the saw fence from the path of the work piece.

Push stick



A

Kickback

- Avoid kickback (when the work piece is thrown against the operator). Keep the disc sharp, saw fence parallel to the cut-off wheel, spreader, pusher and guard installed in place, aligned and working properly.
- Do not let go of the work piece until it overlaps the disc and does not cut across the grain with warped or bucked wood; or does not have a straight edge that prevents it from being guided along the sawing guide.
- Be sure not to cut wood with nails or screws.

Additional precautions

- The equipment should be operated only by persons experienced in its use or instructed and trained in woodworking with stationary machines.
- Wear a dust mask to reduce the risk of inhaling hazardous dusts.
- Wear hearing protection.
- Equipment can throw debris into the eyes during operation, causing severe or permanent damage. Always wear safety glasses that comply with ANSI Z87.1.



- Use care when handling the cut-off wheels inside and outside the equipment to avoid cuts, wear gloves.
- Do not attempt to remove chips while the disc is moving and the power is on.
- Never stand on the equipment.

⚠ WARNING • DO NOT ASSEMBLE the equipment until you are sure that it is not plugged in and that the power switch is in the off position.

⚠ WARNING • DO NOT CONNECT the equipment to the power supply until it is completely assembled and you have read and fully understood these instructions.

- For proper maintenance, there must be sufficient space around the machine.

⚠ CAUTION • Do not use metal cutting discs, this saw is not intended for cutting metal materials or masonry. Doing so could cause severe damage.

Unpacking

- The equipment has been carefully packed for safe transport. Remove the packing material from the machine and inspect it. In case of damage, immediately call the **TRUPER** Authorized Service Center for instructions.

- Save the containers and packing materials to provide for future shipments for the carrier to use. Failure to do so will complicate the shipment.

⚠ CAUTION • Keep a 12" clearance around the machine to give the machine room to move. In case you are working with long materials, you must have enough space at the front and back of the machine to be able to get the material in and out comfortably.

- Unpack the equipment and check that it has not been damaged during transportation.
- Clearly identify the individual parts shown in the parts list.

1. Legs A (X4)
2. Long crossbeams B (X2)
3. Short crossbeams C (X2)
4. Dust suction hose.
5. Retractable guard.
6. Push stick.
7. Auxiliary guide.
8. Sawing guide.
9. Rear supports (X2)
10. Auxiliary supports for sawing guide (X2).
11. Spacer.
12. Anti-slip base (X4)
13. Miter guide.
14. Hardware bag 1 (20 bolts / 20 nuts)
15. Hardware bag 2 (2 bolts / 2 wing nuts)
16. Table saw.
17. Wrenches (X2).

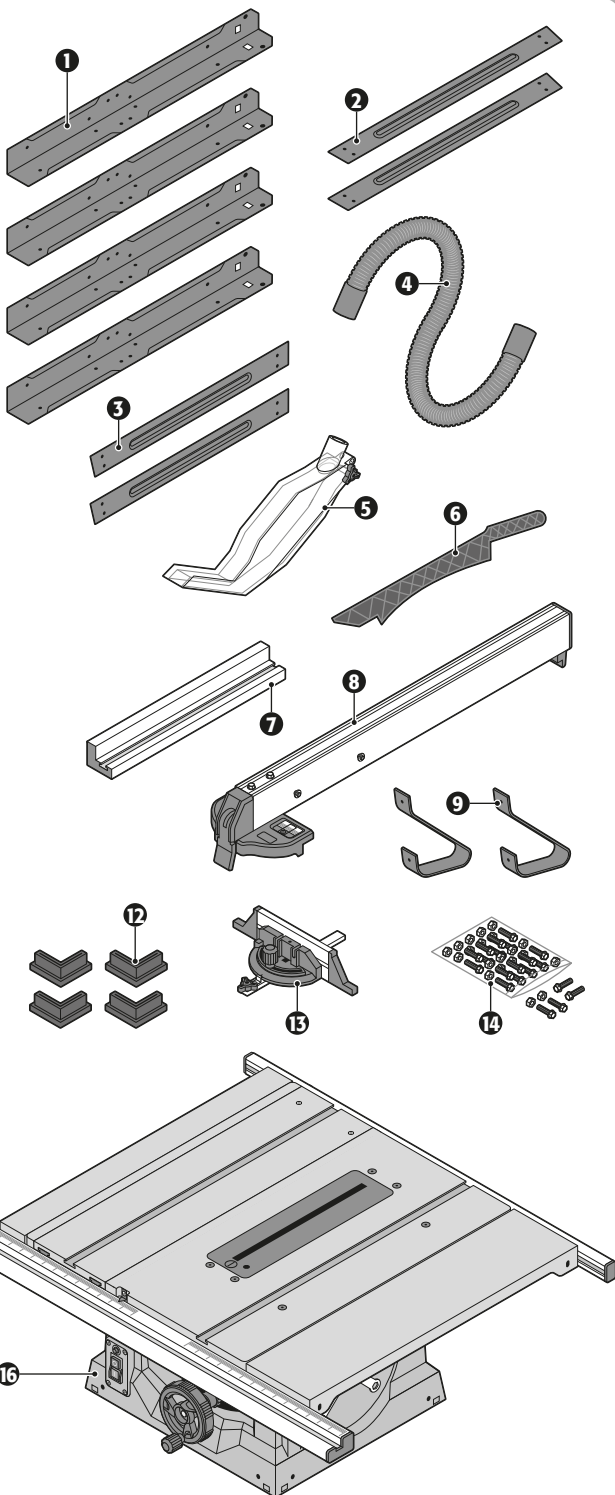
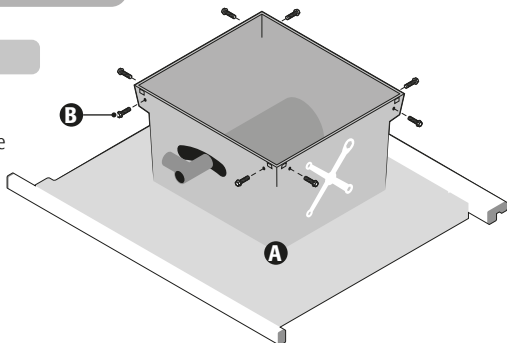
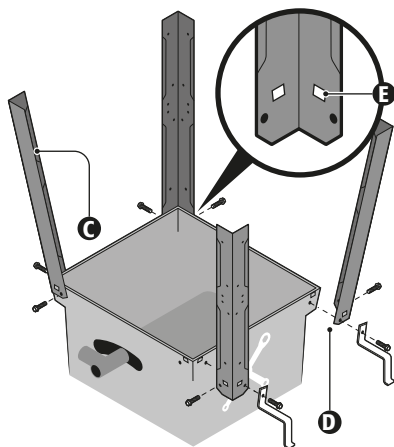

Table base

- With the help of another person turn the table and motor cabinet assembly over and place it on a flat, level and solid surface (A). Then remove the 8 screws from the corners of the cabinet (B).
- Use the removed screws to mount the four legs to the cabinet (C). On the side of the key holder place an auxiliary bracket (D) over each leg and the cabinet.
- ⚠ **CAUTION** • Verify that the holes in the four legs match the square pins in the corners of the cabinet (E).
- Tighten the screws with the included wrench (F).



- Place the shorter cross members C (H) on the shorter side of the table.
- Tighten the bolts with the included wrench (F).



- Position the longer cross members B (G) parallel to the longer side of the table.
- Make sure that the longer side of the 4 cross members (long and short) always face upwards. The markings on crossbar B and C should be oriented towards the outer side.
- Use 2 sets of nuts and bolts for each assembly of all cross members.

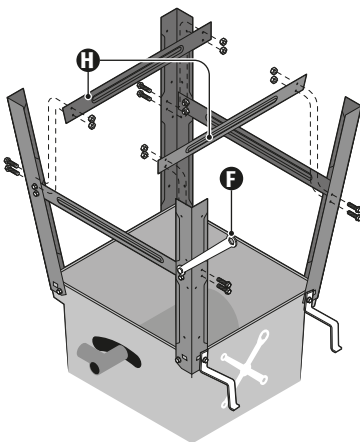

- Attach the 4 non-skid bases (I), one at each end of the legs.

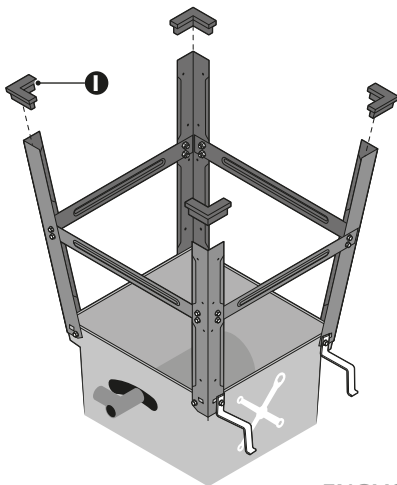
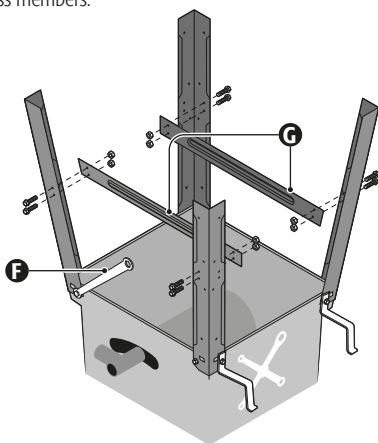

- With the help of another person, rotate the table into its normal position.
- Finally mount the two brackets (**J**), one on each rear leg by means of two sets of nuts and bolts to complete the assembly of the base.

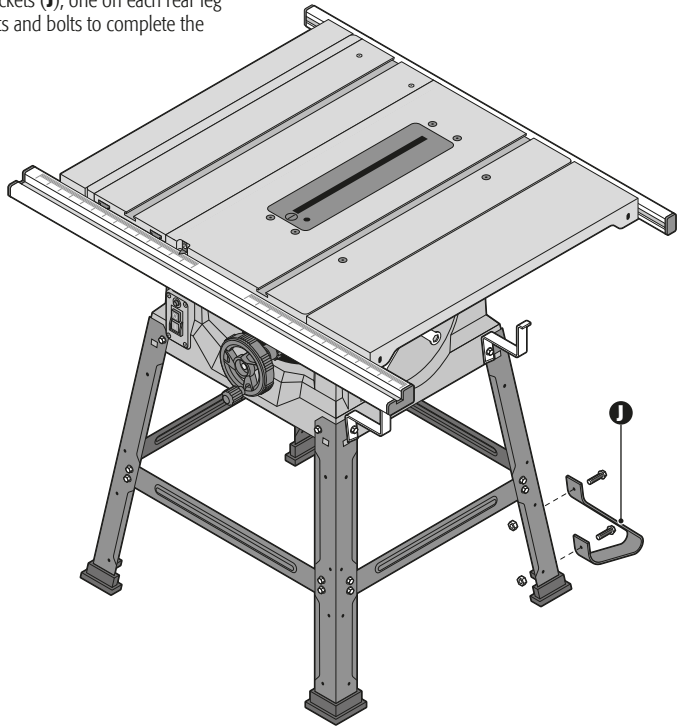

Spacer assembly

- Using a wrench, turn the table insert lock (A) to its open position (B).

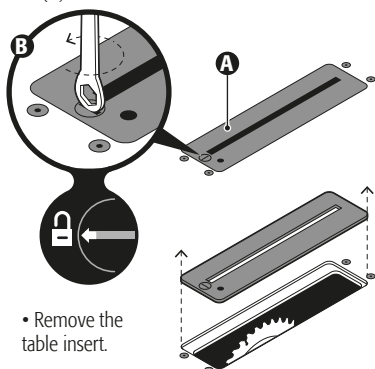

- Remove the table insert.

- Lift the disc (C) to its highest position with the help of the adjusting handwheel (D) (see page 13 Wheel height). And with the help of one of the included wrenches loosen the screw (E) until the spacer can be inserted.

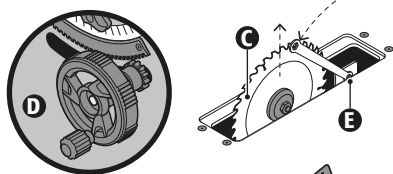

- Insert the spacer (F).

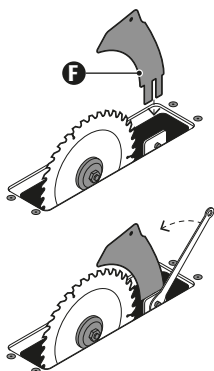

- Tighten with the help of the wrench.

- Lower the disc using the adjusting handwheel, put the table insert back in place and turn the lock to secure the insert.

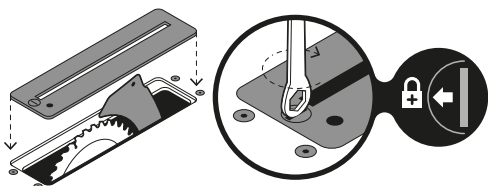

Retractable guard assembly

- Assemble the retractable guard (G) with the bolt (H) in the upper hole of the spacer (I).

CAUTION • Do not screw the bolt too tightly; the guard should move freely.

WARNING • The guard must always be lowered onto the workpiece before starting the sawing operation.

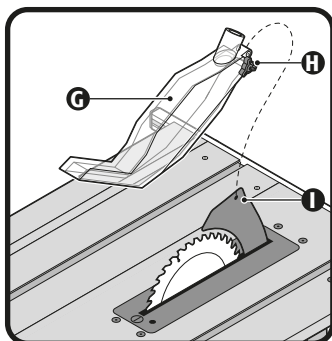

Dust suction hose

- Place one end of the dust suction hose into the retractable guard (J) inserting it fully into the coupling, and the other end into the chip ejection dust (I) perpendicularly to the disc at the rear of the cabinet.

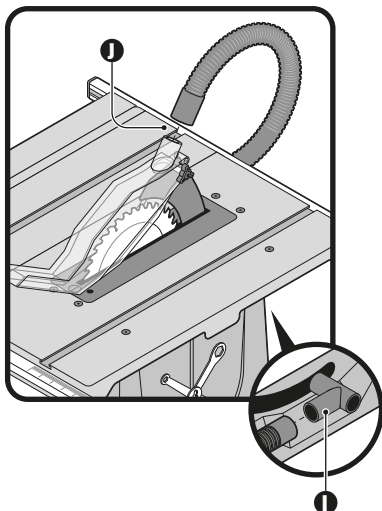

Sawing guide

- Lift the locking lever (A) of the sawing guide head.
- Rest the guide head on the front rail (B) and the rear stop on the rear rail (C).
- Lower the lever to secure the saw fence in position.
- The saw fence rests on both rails.

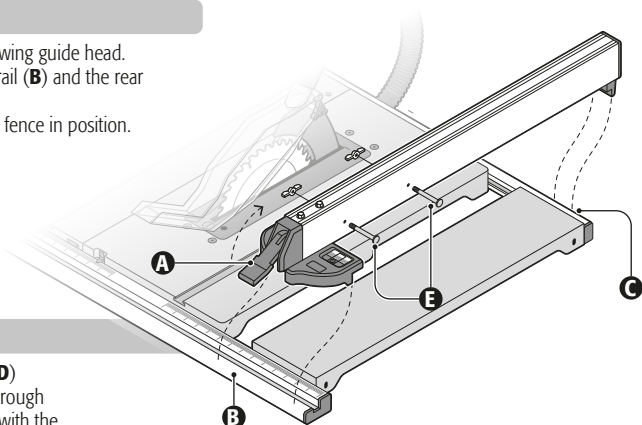

Auxiliary guide

- Before fitting the auxiliary guide (D) you must place the two bolts (E) through the sawing guide and secure them with the wing nuts (Make sure not to tighten the bolts completely).
- Pass the slot of the auxiliary guide (F) through the heads of the bolts to place it in the sawing guide.
- Tighten the wing nuts to secure the auxiliary fence in place.
- The auxiliary fence can be mounted to the left or right of the saw fence (G) depending on the job to be done.

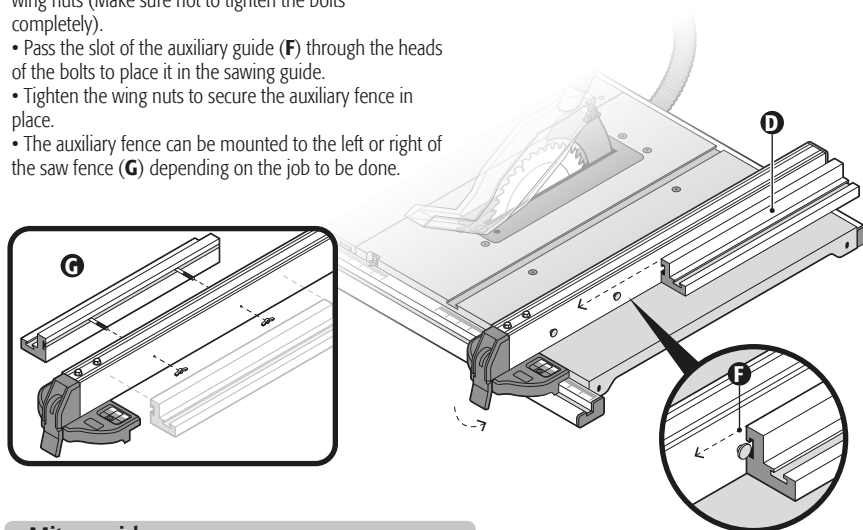

Miter guide

- The miter gauge (H) can be placed in the sliding table slot (I) or in the worktable slot (J).
- You can secure the miter gauge to the sliding table (I) by tightening the screw with the knob (K).

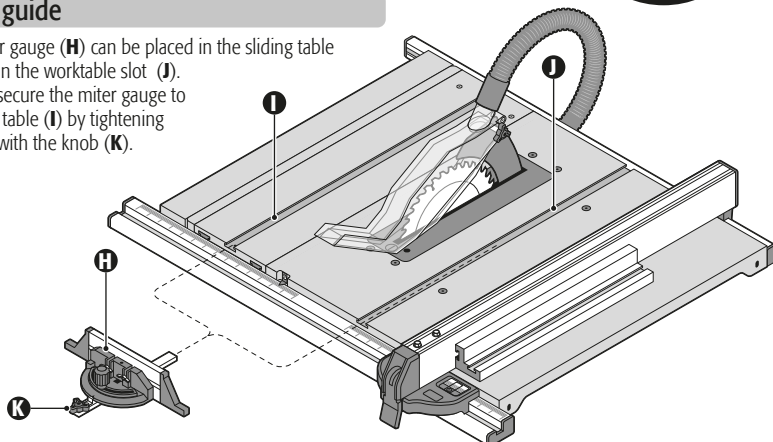

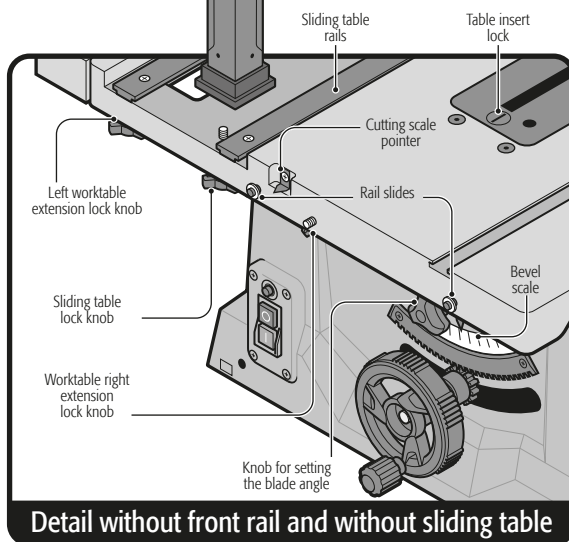
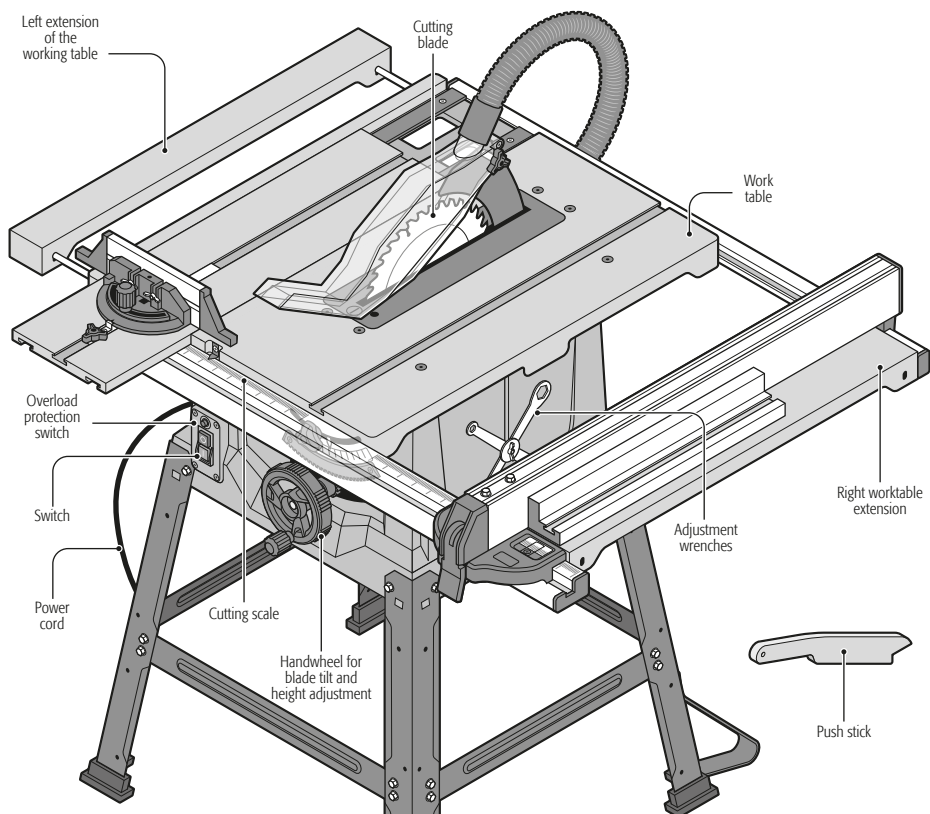

Accessory brackets

- The saw is equipped with different supports in which the accessories can be placed when not in use.

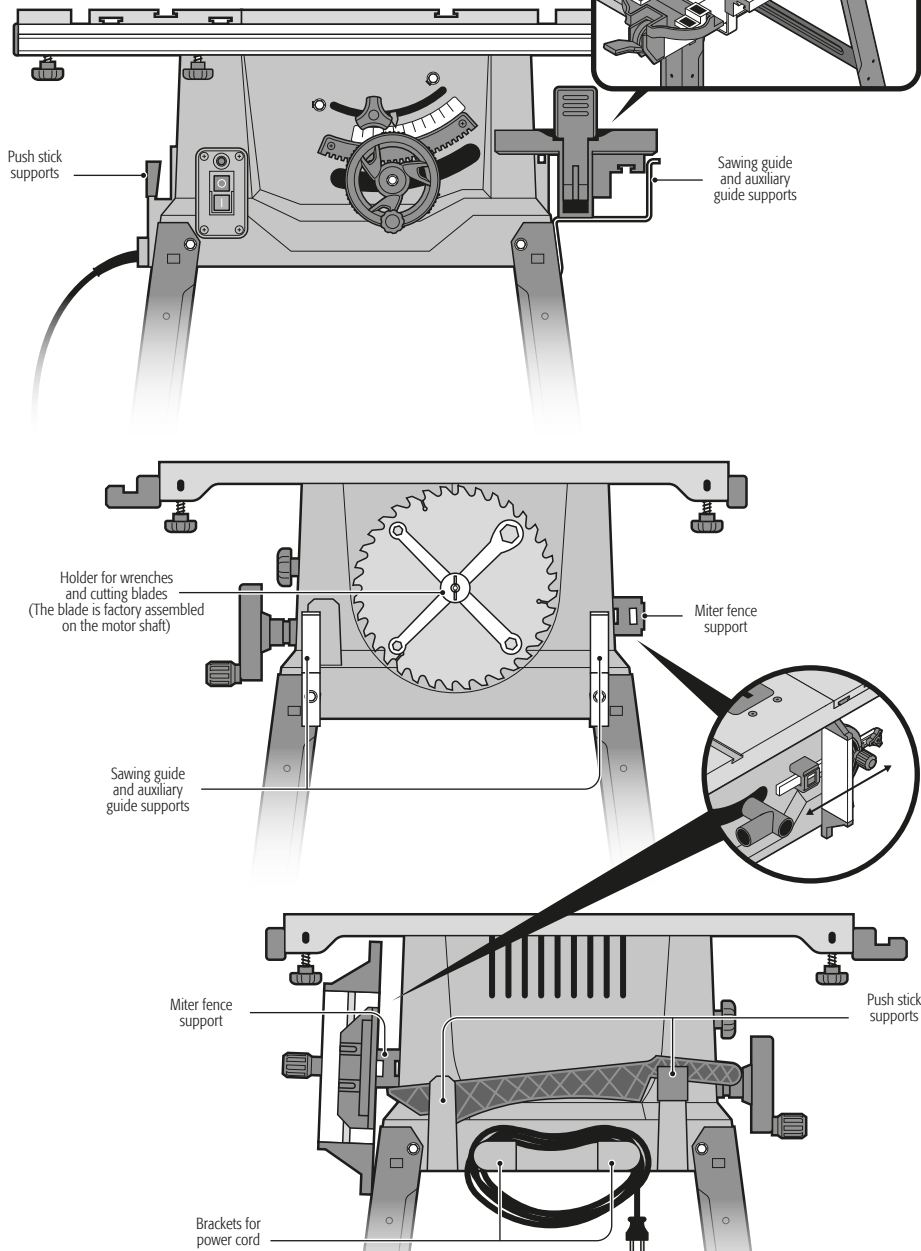

Settings

⚠ WARNING • Before making any adjustments be sure to turn off and unplug the saw.

Blade height

⚠ CAUTION • The blade height should be adjusted so that the tips of the blade teeth are above the surface of the workpiece by approximately 1/8" to 1/4", and the grooves are below the surface of the workpiece.

- Turn the cutting angle lock knob (A) counterclockwise to loosen and tighten by turning the opposite way.
- Raise the blade by turning the height and angle adjustment handwheel (B) clockwise, or lower it by turning the handwheel counterclockwise.

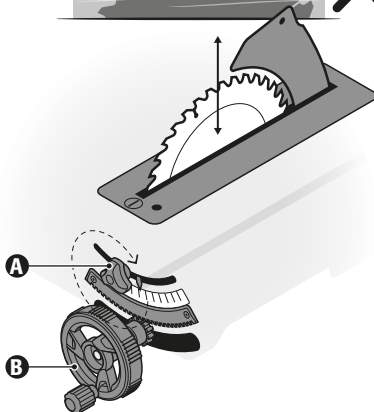
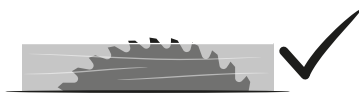

Disk angle

- The rack and pinion mechanism for adjusting the cutting angle allows the blade to be adjusted at angles from 0° to 45°.
- Turn the cutting angle lock knob (A) counterclockwise to loosen it.
- Push the handwheel all the way in until the gear engages the rack, turn the height and angle adjustment handwheel (B) counterclockwise to tilt the blade to the desired angle.
- Finally tighten the cutting angle lock knob to secure the blade angle.

Important: If it is necessary to adjust to a greater angle than the scale, the user should follow these instructions:

- Loosen the adjustment stop screw and move it to the maximum right side (this allows for an increased stroke and angle of the bevel).
- Rotate the steering wheel (B) counterclockwise to the required angle.
- Secure the stop screw by tightening it and lock the cutting angle position with the cutting angle lock knob (A).

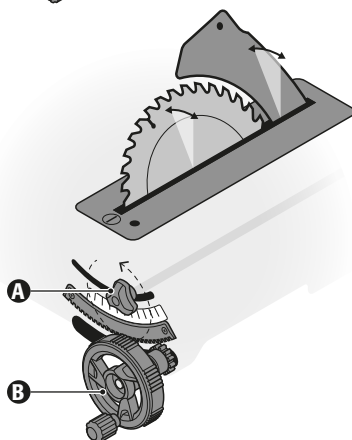

Use of table extensions

- Right table extension (**A**): To traverse and increase the table length, loosen the locking knobs (**B**) located under the table, one at the front and the other at the rear.
- Travel the rails until the extension reaches the desired position.
- Tighten both locking knobs to secure the extension in position.

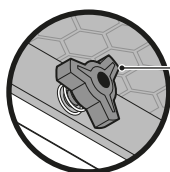

B

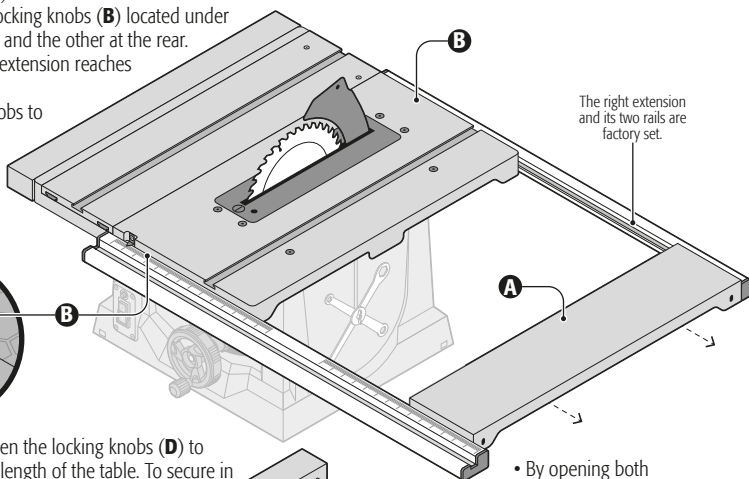

- Left extension (**C**): Loosen the locking knobs (**D**) to traverse and increase the length of the table. To secure in position, retighten the knobs.

The left extension is factory assembled.



D

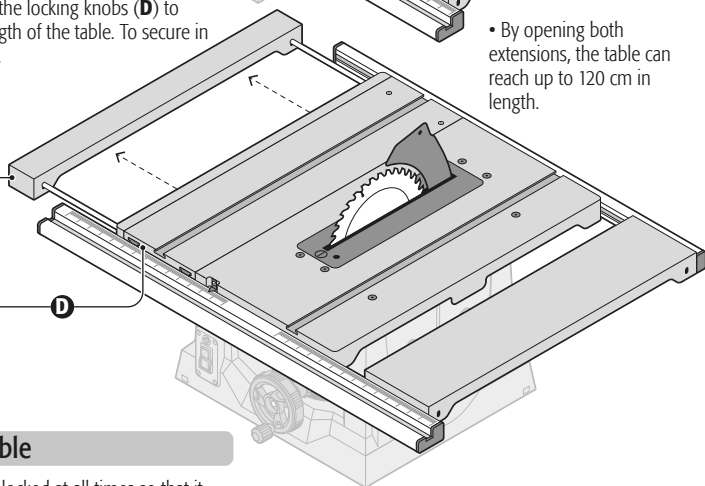

Use of the sliding table

- To keep the sliding table unlocked at all times so that it can be used together with the miter gauge, pull down the knob (**G**) and turn it 90° so that the lock does not take effect.

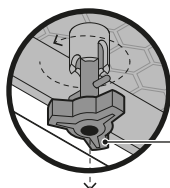

G

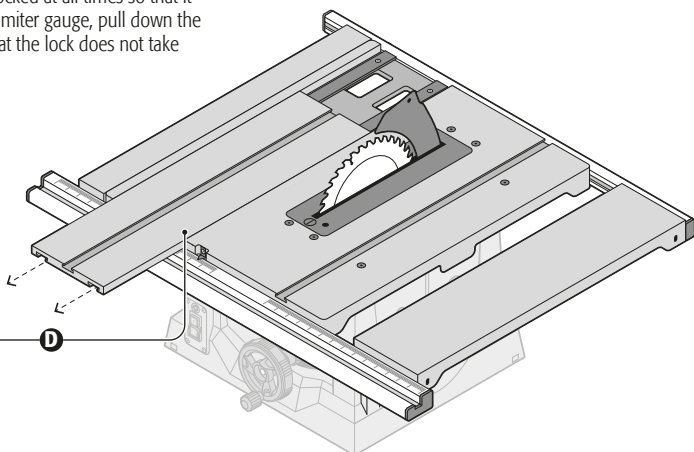

Adjusting the miter gauge

- Loosen the clamping handle (A) to allow the fence frame to rotate freely to the desired angle. The fence can be adjusted from 0° to 60° left and right.
- The front bumper (B) can slide left and right by loosening the two wing nuts. This will give a better adjustment during use.
- If the angle indicator (C) requires adjustment, loosen the screw with a crosshead screwdriver. Adjust the indicator to 0° of scale and then tighten firmly.
- The knob (D) is for attaching the miter gauge to the sliding table (see pages 10 and 14).

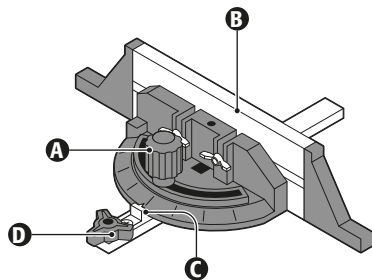

Disc replacement

- Remove the retractable guard (E) from the spacer.
- Remove the table insert (F) to gain access to the washer area.
- Using the handwheel (G) adjust the disc to its maximum height and at 0° angle. Ensure that the cutting angle lock knob (H) is tightened securely to prevent the mechanism from moving during blade change.
- Insert the wrench into the disc washer (I).
- Insert the other wrench on the nut securing the blade (K). Holding both wrenches firmly, pull the wrench holding the nut (K) toward the front while pushing the wrench holding the washer (I) toward the back of the saw.
- Remove the nut and then the disc.
- Loosen the two screws (L) of the spacer bracket until it allows you to move it.
- With the screws loosened move the spacer bracket to the right as far as possible.
- Keeping the bracket in the right position, tighten the two screws.
- Place the new blade on the spindle (the teeth should point towards the front of the saw).
- Place the washer and nut on the shaft. Make sure the washer is oriented in its original position.
- Tighten the blade nut without overtightening.

CAUTION • Use a glove to turn the blade by hand to confirm that it turns freely.

- Lower the saw blade and position the table insert.

NOTE To replace a standard blade with a different accessory, follow the instructions provided with the accessory.

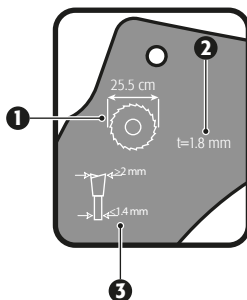
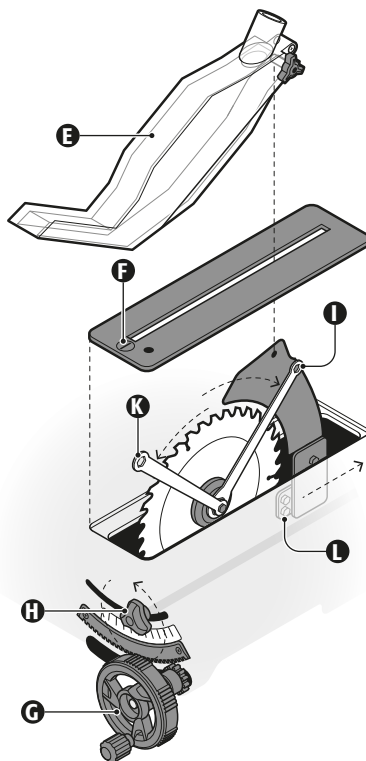

1. The diameter of the blade should not exceed 10"
2. The thickness of the spacer is 1/16"
3. When changing the disc, make sure that the cutting width is not less than 5/64" and that the thickness of the base disc is not more than 1/16" Otherwise there is a risk of the spreader getting caught in the workpiece.

- Handling power tools involve some danger to the operator. Before attempting regular work, we recommend familiarizing yourself with the operations using scrap wood to check the settings.
- Read all instructions before starting to cut the workpiece.

Always heed safety warnings to avoid personal injury.

⚠ WARNING Make sure the guard and spreader are installed and functioning properly to avoid possible serious injury.

Switching on and off

- To turn the saw on, press the green button (I).
- Wait for the blade to reach its maximum rotational speed before starting the cut.
- To turn the machine off, press the red button (O).

Electrical overload protection

- The saw is equipped with an overload protection switch (G). If an overload occurs the circuit breaker will trip and the motor will shut down. To reset the motor, follow the steps below:
 1. Place the switch in the off position "O".
 2. Allow the saw to cool for at least 5 minutes.
 3. Press the overload protection switch.
 4. Turn the switch to the on position "I" to turn the saw on.

Protection against accidental start-up

- The protection operates once the saw loses power supply for some uncontrolled reason.
- To reset, remove the plug from the power supply and reconnect.
- Once the plug is connected to the power supply, turn the saw on with the switch.

NOTE • It is recommended that tests be made on scrap wood to become familiar with the safest and most efficient procedure before beginning work on the final workpiece.

- Wait for the blade to reach full speed before feeding the workpiece.
- Never use the miter fence in combination with the saw fence to make the same cut.
- Be sure to tighten the lock knobs on all accessories and controls securely before making a cut.

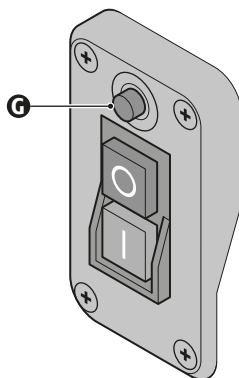

Cutting across the wood grain

- Place the workpiece against the miter gauge (A) and advance the workpiece by pushing it with the miter gauge towards the disc.
- Start the cut slowly and push the workpiece with a steady, continuous motion.
- Once the cut is made, move the workpiece slightly away from the disc and return the miter gauge together with the workpiece to its original position.
- Never stop, pick up or touch workpieces that are loose on the table when cutting with the blade in motion unless they are at least 11.8" long.
- Never use the miter gauge to make cuts across the grain.
- The miter gauge can be mounted in either of the two slots in the table.
- To make miter cuts adjust the miter gauge to the desired angle, the picture shows a cut made with the gauge at 30° (a).
- When making bevel cuts (with the disc at an angle) use the right table slot so that you do not expose your hands to the moving wheel teeth.

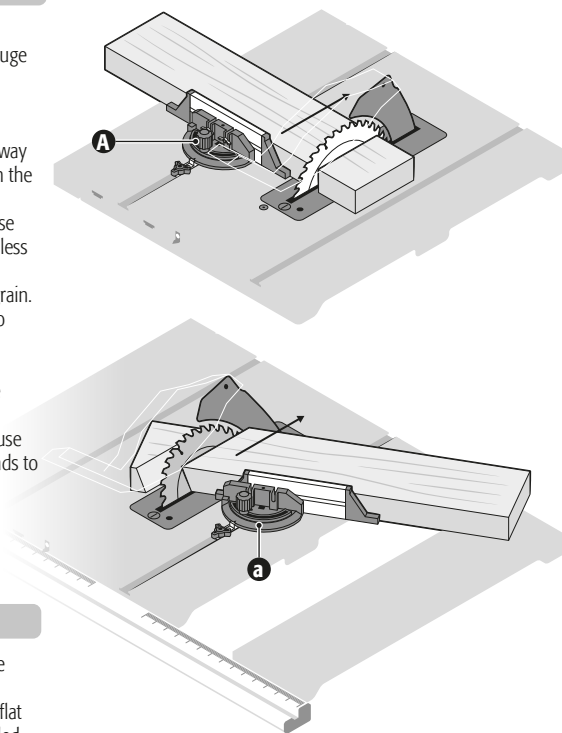

Cutting along the grain of the wood

- Place the edge of the workpiece against the saw fence (B) and the flat side on the table.
- The edge against the saw fence must be straight and flat so that the workpiece can be safely and accurately guided by the saw fence as it is pushed towards the disc.
- Hold the workpiece with both hands and push it along the sawing guide towards the disc. Once cutting has started, the workpiece can be held with one or two hands.
- At the end of the cut, depending on its size, the workpiece may remain on the table, be caught by the back of the guard, or slide off the table onto the floor. When the workpieces remain on the table they can be lifted up and returned on the opposite side of the saw fence disc.
- Never stop, pick up or touch workpieces that are loose on the table when cutting with the blade in motion unless they are large enough to be removed safely.
- It is important to have the guard and spreader properly mounted to prevent kickback and to prevent the cut from closing after passing through the disc.
- When making bevel cuts (with the disc at an angle) use the saw fence on the right side of the table so that you do not expose your hands to the teeth of the moving wheel, or the workpiece will jam between the wheel and the saw fence.

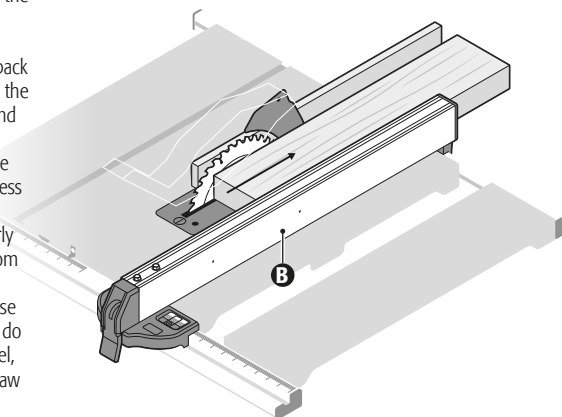

Cutting of small parts

⚠ WARNING • If you are going to make cuts in small pieces or lengthwise cuts in narrow strips of wood, always use the included stick (A) and the auxiliary guide (B) so as not to operate the saw with your hands near the moving blade.

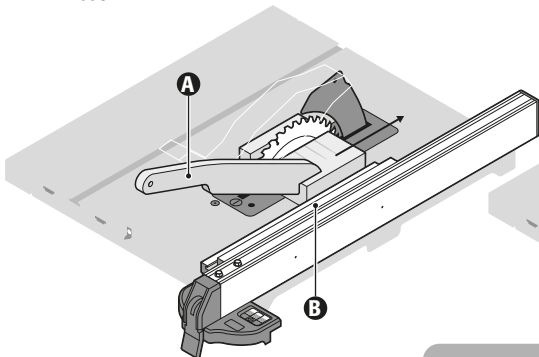

Groove cutting

- Remove the spacer (C) to be able to make groove cuts.
- Slotting can be performed with normal blades.

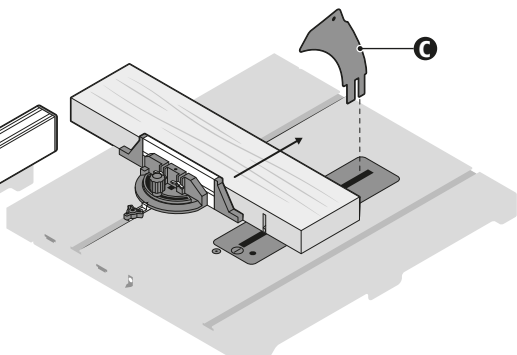

Maintenance

Cleaning and lubrication

- It is recommended that the inside of the saw be cleaned every 5 hours of use or when the blade height and angle control mechanisms do not operate freely.
- Turn off and unplug the saw.
- Remove it from its base and turn it over.
- With a stiff bristle brush and vacuum cleaner remove all dust, paying CAUTION! to the mechanisms and motor air inlet.
- Apply dry graphite or silicone lubricant to the mechanisms. **⚠ CAUTION** Do not use oil or grease, as they will accumulate sawdust and hinder the operation of the mechanisms.
- The motor bearings are sealed and lubricated at the factory; no additional lubrication is required.

Service

- Service should only be performed by personnel from a **TRUPER®** Authorized Service Center.
- Service and maintenance performed by unqualified persons may be dangerous and may result in personal injury and invalidate the product warranty.

Change of carbon brushes

- The carbon brushes should be checked periodically, and always be replaced by a **TRUPER®** Authorized Service Center when worn out.
- After replacement, have the new carbon brushes checked to see if they move freely in the carbon brush holder and turn the tool on for 5 minutes to match the contact of the carbon brushes and commutator.
- Only **TRUPER®** original spare carbon brushes should be used specifically designed with the appropriate hardness and electrical resistance for each type of motor. Out of specification carbon brushes can damage the motor.
- When changing carbon brushes, always replace both.

Disc maintenance

- Once the discs wear out, they should be replaced immediately.
- The discs specified for this tool are 10". Never use any other type or size disc. Failure to do so may result in serious personal injury or damage to the tool and void your warranty.
- Never use damaged or incorrect washers and bolts when replacing the disc. The included bolts and washers are specially designed for this model tool for excellent performance and safe operation.
- Use discs with holes of the correct size and shape for the shaft. Otherwise, they may rotate with an eccentric motion causing loss of control.

Problem

Cause

Solution

The saw will not start.

- Cable disconnected from power supply.
- Overload protection switch activated.
- Damaged cable.
- Protection against accidental starting.

- Connect the power supply cable.
- Reset the overload protection switch (see page 16).
- Replace the cable.
- Remove the plug from the power supply and reconnect.

The overload protection switch is frequently activated.

- Extension cord or wiring is incorrectly sized.
- Power is being fed too fast.
- Blade needs cleaning or replacement.
- Blade is jammed with the workpiece against the saw fence.
- Blade is jammed with bucked wood.
- Low local power.

- Replace extension cord or wiring with correct gauge.
- Reduce the feed speed.
- Clean or replace blade.
- Check and adjust the alignment of the saw fence.
- Work another piece of wood that is not warped.
- Call your power company.

The angle of the cuts is not precise.

- The miter gauge or saw fence is misaligned.

- Correctly adjust the miter gauge or saw fence and tighten its knobs securely.

The material gets stuck in the disc.

- Sawing guide is misaligned.
- The blade is jammed with buckled wood.

- Check and adjust the alignment of the saw fence.
- Work another piece of wood that is not warped.

The material gets stuck in the spacer.

- The spacer is misaligned.

- Check and adjust the spacer alignment.

The cuts are not satisfactory.

- Blunt or damaged disc.
- Disc is mounted the other way around.
- Disc has tar or resin on it
- Disc is not suitable for the job.
- The table has tar or resin that hinders feeding.

- Replace the disc.
- Reposition the disc.
- Remove the disc and clean it with turpentine and steel fiber.
- Replace the disc.
- Clean the table with turpentine and steel fiber.

Disk does not reach full speed.

- Extension cord or wiring is incorrectly sized.
- Low local power.

- Replace the extension cord or wire with the correct gauge.
- Call your power company.

The unit vibrates excessively.

- The unit is on an uneven floor.
- The disc is damaged.

- Place the unit on a flat and level floor.
- Replace the disc.

Disk does not lift or tilt freely.

- The control mechanisms are dirty.

- Brush or blow out all debris accumulated on the control mechanisms.

The material is returned by the movement of the disk.

- The sawing guide is misaligned.
- The spacer is misaligned.
- Material feeding without sawing guide.
- Spacer not installed.
- Cutting blade dull or worn.
- Material comes loose before passing through the blade.
- Miter gauge knob is loose.

- Adjust the angle of the sawing guide.
- Adjust the angle of the spacer.
- Support the material on the sawing guide.
- Place the spacer.
- Replace the blade with another one in good condition.
- Hold and push the material with the help of sticks and the pusher block until it has passed through the blade.
- Tighten the knob on the miter gauge.

If problems persist despite performing the recommended corrective actions, contact a  **TRUPER** Authorized Service Center.

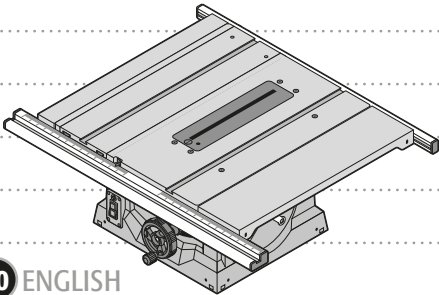

In the event of any problem contacting a Truper Authorized Service Center, please see our webpage www.truper.com to get an updated list, or call our toll-free numbers **800 690-6990** or **800 018-7873** to get information about the nearest Service Center.

AGUASCALIENTES **DE TODO PARA LA CONSTRUCCIÓN**
GRAL. BARRAGÁN #1201, COL. GREMIAL, C.P. 20030,
AGUASCALIENTES, AGS. TEL.: 449 994 0537

BAJA CALIFORNIA **SUCURSAL TIJUANA**
AV. LA ENCANTADA, LOTE #5, PARQUE INDUSTRIAL EL
FLORIDO II, C.P. 2244, TIJUANA, B.C.
TEL.: 664 969 5100

BAJA CALIFORNIA SUR **FIX FERRETERÍAS**
FELIPE ÁNGELES ESQ. RUIZ CORTÍNEZ S/N, COL. PUEBLO
NUEVO, C.P. 23670, CD. CONSTITUCIÓN, B.C.S.
TEL.: 613 132 1115

CAMPECHE **TORNILLERÍA Y FERRETERÍA AAA**
AV. ÁLVARO OBREGÓN #324, COL. ESPERANZA
C.P. 24080 CAMPECHE, CAMP. TEL.: 981 815 2808

CHIAPAS **FIX FERRETERÍAS**
AV. CENTRAL SUR #27, COL. CENTRO, C.P. 30700,
TAPACHULA, CHIS. TEL.: 962 118 4083

CHIHUAHUA **SUCURSAL CHIHUAHUA**
AV. SILVESTRE TERRAZAS #128-11, PARQUE INDUSTRIAL
BAFAR, CARRETERA MÉXICO CUAUHTÉMOC, C.P. 31415,
CHIHUAHUA, CHIH. TEL.: 614 434 0052

CIUDAD DE MÉXICO **FIX FERRETERÍAS**
EL MONSTRUO DE CORREGIDORA, CORREGIDORA # 35,
COL. CENTRO, C.P. 06060, CUAUHTÉMOC, CDMX.
TEL.: 55 5522 5031 / 5522 4861

COAHUILA **SUCURSAL TORREÓN**
CALLE METAL MECÁNICA #280, PARQUE INDUSTRIAL
ORIENTE, C.P. 27278, TORREÓN, COAH.
TEL.: 871 209 68 23

COLIMA **BOMBAS Y MOTORES BYMTESA DE MANZANILLO**
BLVD. MIGUEL DE LA MADRID #190, COL. 16 DE
SEPTIEMBRE, C.P. 28239, MANZANILLO, COL.
TEL.: 314 332 1986 / 332 8013

DURANGO **TORNILLOS ÁGUILA, S.A. DE C.V.**
MAZURIO #200, COL. LUIS ECHEVERRÍA, DURANGO,
DGO. TEL.: 618 817 1946 / 618 818 2844

ESTADO DE MÉXICO **SUCURSAL CENTRO JILOTEPEC**
PARQUE INDUSTRIAL # 1, COL. PARQUE INDUSTRIAL
JILOTEPEC, JILOTEPEC, EDO. DE MÉX. C.P. 54257
TEL.: 761 782 9101 EXT. 5728 Y 5102

GUANAJUATO **CÍA. FERRETERA NUEVO MUNDO S.A. DE C.V.**
AV. MÉXICO - JAPÓN #225, CD. INDUSTRIAL, C.P. 38010,
CELAYA, GTO. TEL.: 461 617 7578 / 79 / 80 / 88

GUERRERO **CENTRO DE SERVICIO ECLIPSE**
CALLE PRINCIPAL MZ 1 LT. 1, COL. SANTA FE, C.P. 39010,
CHILPANCIÑO, GRO. TEL.: 747 478 5793

HIDALGO **FERREPRECIOS S.A. DE C.V.**
LIBERTAD ORIENTE #304 LOCAL 50, INTERIOR DE PASAJE
ROBLEDO, COL. CENTRO, C.P. 43600, TULANCINGO,
HGO. TEL.: 775 753 6615 / 775 753 6616

JALISCO **SUCURSAL GUADALAJARA**
AV. ADOLFO B. HORN # 6800, COL. SANTA CRUZ DEL
VALLE, C.P.: 45655, TLAJOMULCO DE ZUÑIGA, JAL.
TEL.: 33 3606 5285 AL 90

MICHOACÁN **FIX FERRETERÍAS**
AV. PASEO DE LA REPÚBLICA #3140-A, COL.
EX-HACIENDA DE LA HUERTA, C.P. 58050, MORELIA,
MICH. TEL.: 443 334 6858

MORELOS **FIX FERRETERÍAS**
CAPITÁN ANZURES #95, ESQ. JOSÉ PERDIZ, COL.
CENTRO, C.P. 62740, CUAUTLA, MOR.
TEL.: 735 352 8931

NAYARIT **HERRAMIENTAS DE TEPIC**
MAZATLAN #117, COL. CENTRO, C.P. 63000, TEPIC, NAY.
TEL.: 311 258 0540

NUEVO LEÓN **SUCURSAL MONTERREY**
CARRETERA LAREDO #300, 1B MONTERREY PARKS,
COLONIA PUERTA DE ANAHUAC, C.P. 66052, ESCOBEDO,
NUEVO LEÓN, TEL.: 81 8352 8791 / 81 8352 8790

OAXACA **FIX FERRETERÍAS**
AV. 20 DE NOVIEMBRE #910, COL. CENTRO, C.P. 68300,
TUXTEPEC, OAX. TEL.: 287 106 5092

PUEBLA **SUCURSAL PUEBLA**
AV. PERIFÉRICO #2-A, SAN LORENZO ALMECATLA,
C.P. 72710, CUAUHTLACINGO, PUE.
TEL.: 222 282 8282 / 84 / 85 / 86

QUERÉTARO **ARU HERRAMIENTAS S.A. DE C.V.**
AV. PUERTO DE VERACRUZ #110, COL. RANCHO DE
ENMEDIO, C.P. 76842, SAN JUAN DEL RÍO, QRO.
TEL.: 427 268 4544

QUINTANA ROO **FIX FERRETERÍAS**
CARRETERA FEDERAL MZ. 46 LT. 3 LOCAL 2, COL. EJIDAL,
C.P. 77710 PLAYA DEL CARMEN, Q.R.
TEL.: 984 267 3140

SAN LUIS POTOSÍ **FIX FERRETERÍAS**
AV. UNIVERSIDAD #1850, COL. EL PASEO, C.P. 78320,
SAN LUIS POTOSÍ, S.L.P. TEL.: 444 822 4341

SINALOA **SUCURSAL CULIACÁN**
AV. JESÚS KUMATE SUR #4301, COL. HACIENDA DE LA
MORA, C.P. 80143, CULIACÁN, SIN.
TEL.: 667 173 9139 / 173 8400

SONORA **FIX FERRETERÍAS**
CALLE 5 DE FEBRERO #517, SUR LT. 25 MZ. 10, COL.
CENTRO, C.P. 85000, CD. OBREGÓN, SON.
TEL.: 644 413 2392

TABASCO **SUCURSAL VILLAHERMOSA**
CALLE HELIO LOTES 1, 2 Y 3 MZ. #1, COL. INDUSTRIAL,
2A ETAPA, C.P. 86010, VILLAHERMOSA, TAB.
TEL.: 993 355 7244

TAMAULIPAS **VM ORINGS Y REFACCIONES**
CALLE ROSITA #527 ENTRE 20 DE NOVIEMBRE Y GRAL.
RODRÍGUEZ, FRACC. REYNOSA, C.P. 88780, REYNOSA,
TAMS. TEL.: 899 926 7552

TLAXCALA **SERVICIOS Y HERRAMIENTAS INDUSTRIALES**
PABLO SIDAR #132, COL. BARRIO DE SAN BARTOLOMÉ,
C.P. 90970, SAN PABLO DEL MONTE, TLAX.
TEL.: 222 271 7502

VERACRUZ **LA CASA DISTRIBUIDORA TRUPER**
BLVD. PRIMAVERA ESQ. HORTENSIA S/N, COL.
PRIMAVERA C.P. 93308, POZA RICA, VER.
TEL.: 782 823 8100 / 826 8484

YUCATÁN **SUCURSAL MÉRIDA**
CALLE 33 #600 Y 602, LOCALIDAD ITZINCAB Y MULSA,
MPIO. UMAN, C.P. 97390, MÉRIDA, YUC.
TEL.: 999 912 2451

Code	Model	Brand
101796	SME-10B	TRUPER®

Warranty. Duration: 1 year. Coverage: parts, components and workmanship against manufacturing or operating defects, except if used under conditions other than normal; when it was not operated in accordance with the instructive; was altered or repaired by personnel not authorized by **Truper®**. To make the warranty valid, present the product, stamped policy or invoice or receipt or voucher, in the establishment where you bought it or in Corregidora 35, Centro, Cuauhtémoc, CDMX, 06060, where you can also purchase parts, components, consumables and accessories. It includes the costs of transportation of the product that derive from its fulfillment of its service network. . Phone number **800-018-7873**. Made in China. Imported by Truper, S.A. de C.V. Parque Industrial 1, Parque Industrial Jilotepec, Jilotepec, Edo. de Méx. C.P. 54257, Phone number 761 782 9100.

Stamp of the business. Delivery date:

